

Pairing or Adding lock

1. Enable phone Bluetooth and network connection.
2. In "Lock" page, click add icon "+" in center page or top right.

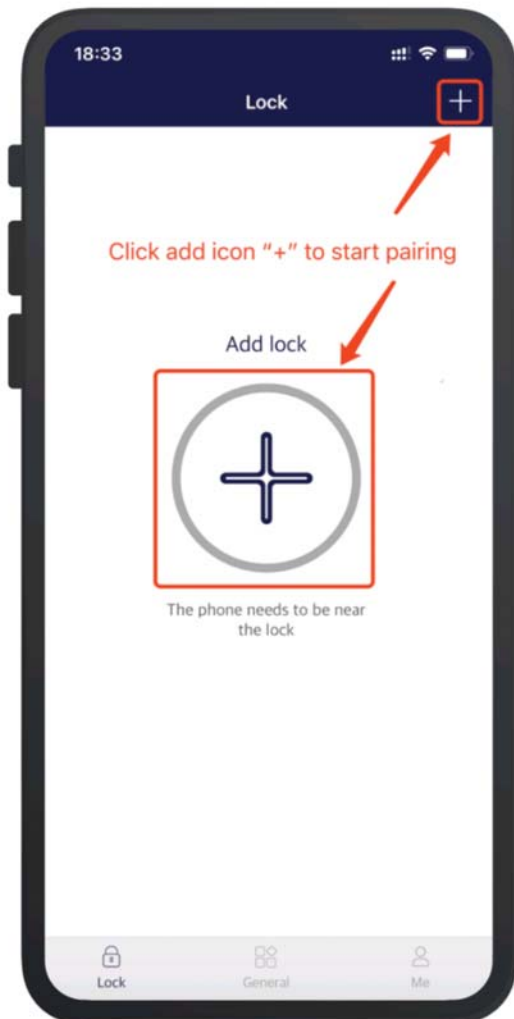

- 3.** Select lock type you want to add (i.e.: Deadbolt).

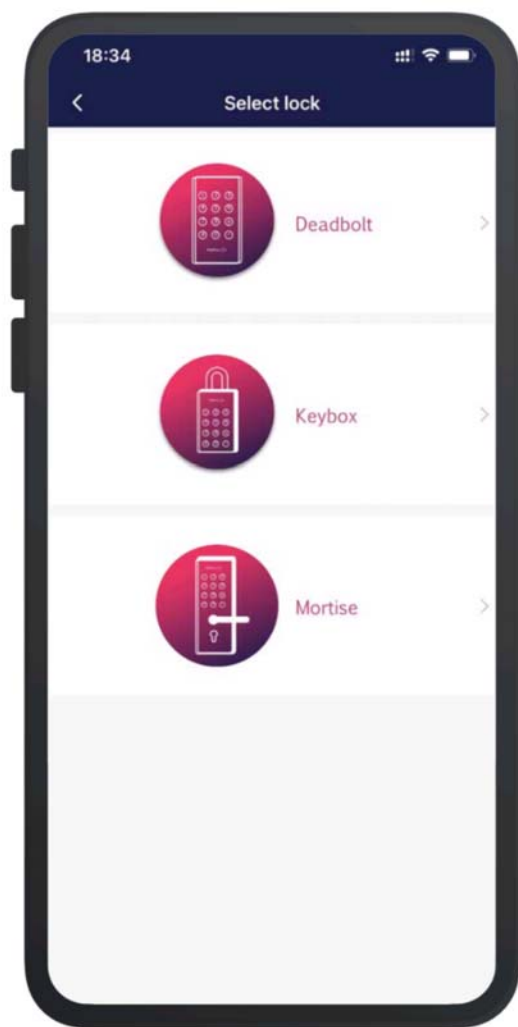

- 4.** A list of lock will show on the phone, which are scanned via Bluetooth.

Touch the lock keypad to activate it until the "+" indicator appears in App, which means the lock is ready for pairing.

Then click the item with "+" to start pairing.

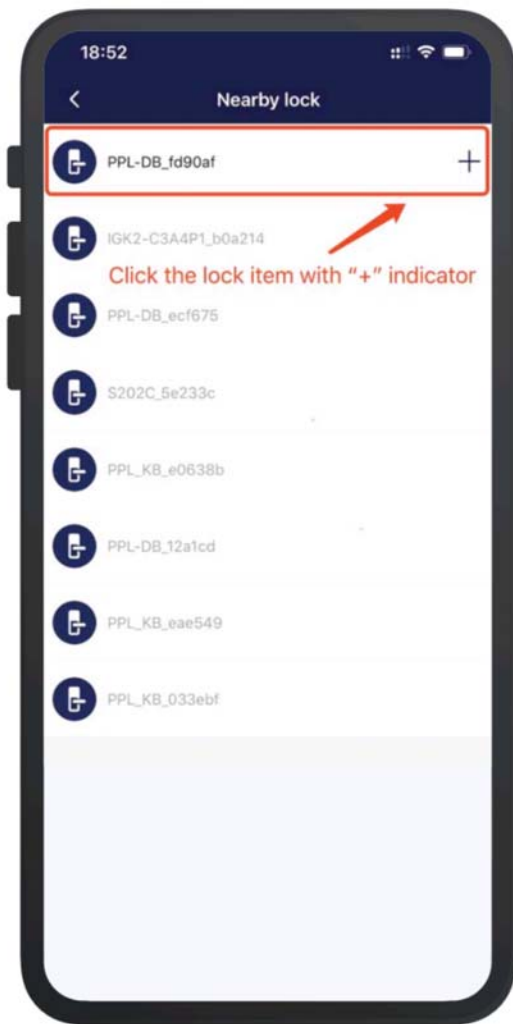

5. Rename the lock (i.e.: "Front door", "Jerry's home" or else)

Note: You can add several locks in the App, name it to distinguish which door you are gonna control.

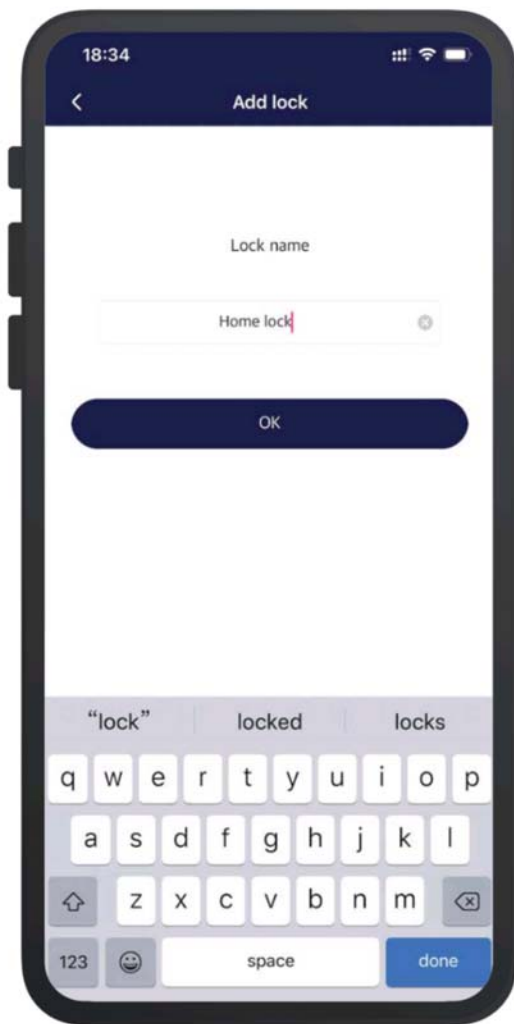

- 6.** Congratulations! You've done with the pairing. You'll return to the lock page, where you can control the lock as you wish. Enjoy your journey with the smart lock.

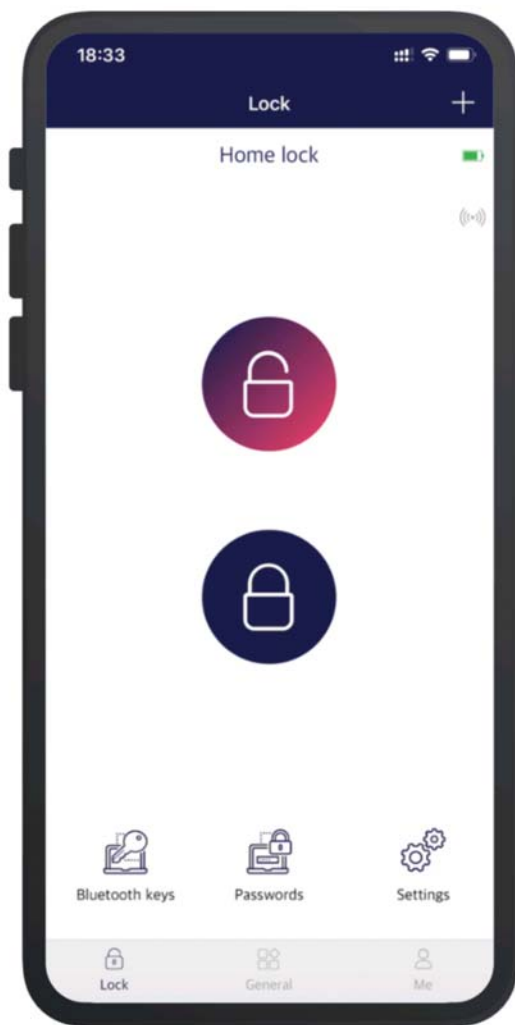

Note: During pairing, keep the lock keypad lit up, and phone Bluetooth and network enabled.

FAQ

In step 4, if the "+" icon doesn't appear when you touch the lock keypad, maybe because the lock has been paired before.

To make it, you can do either of the following:

- If the lock was paired before, please contact the former owner of the lock to delete the lock in App. The "Delete" button can be found at the bottom of "Lock settings" page.

- If the lock is newly bought, you can reset it to factory mode and pair it then.

You can reset the lock by following:

- 1) Get the front panel shown in picture below.
- 2) Long press the RESET button until a beep sound which indicates the lock is already reset.

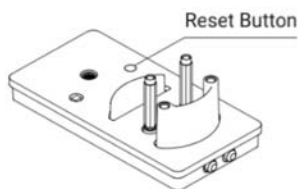

Lock

You can lock the door via App or lock keypad. And the Auto/Manual locking mode is described as below:

Function	Description	Note
Auto/Manual locking mode	<p>- Auto locking mode: (In App) Select lock > Lock settings > Automatic locking > Swipe to the right to turn on auto locking mode > Set time > Select the auto lock time > OK > Save</p> <p>- Manual locking mode: (In App) Select lock > Lock settings > Automatic locking > Swipe to the left to turn to the manual lock > Save</p>	<p>- In auto locking mode: The lock will be locked automatically after a short time that set in App.</p> <p>- In manual locking mode: The lock will not lock automatically. It can be locked via one of the following ways:</p> <ol style="list-style-type: none">1) Long-press # button on lock keypad2) Thumb turn the knob from inside the door3) Click the LOCK icon to lock via Bluetooth in App.

Note: Make sure the phone is close to the lock to operate via Bluetooth smoothly.

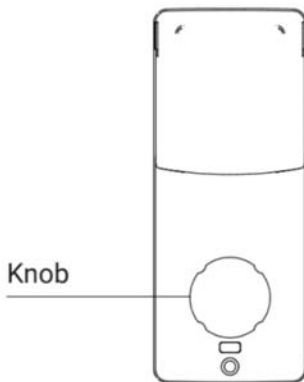

Unlock

1. Unlock via App

In App "Lock" page, click the UNLOCK icon to unlock via Bluetooth.

2. Unlock via Admin password (Master PIN code)

a) In App "Lock" page > Settings > Admin password

b) On lock keypad, enter Admin password, end with "#"
to unlock. (i.e.: 6317958#)

Note: The "#" is the confirm button of the password.

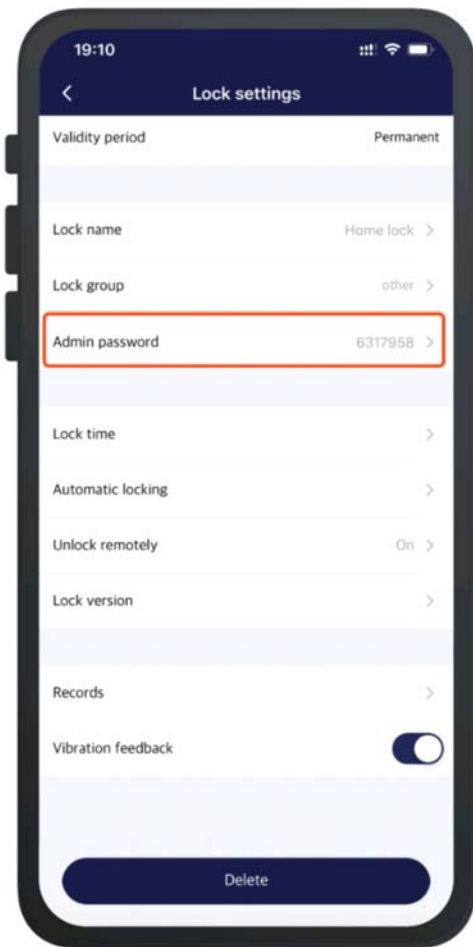

Unlock (Sharing Bluetooth key)

You can send a Bluetooth key for visitors or family members. And they can control the lock via Bluetooth in App.

- 1) In App "Lock" page > Bluetooth keys >  > Send Bluetooth key
- 2) Configure and set Bluetooth key > Send
- 3) Receiver can access the Bluetooth key after signing in, then control the lock via App.

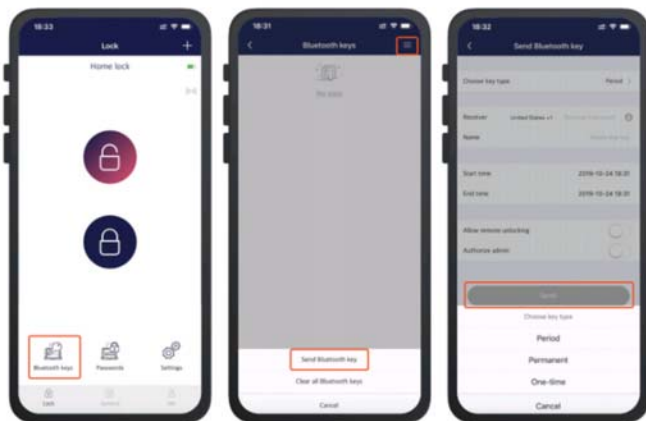

Note: Make sure the receiver's account has already been REGISTERED in Populife App.

Unlock

(Sharing keypad password)

You can also share a keypad password for visitors or family members. And they can unlock by entering it on lock keypad.

- 1) In App "Lock" page > Passwords >  > Create password
- 2) Input password name > Create password > Share via Message or else

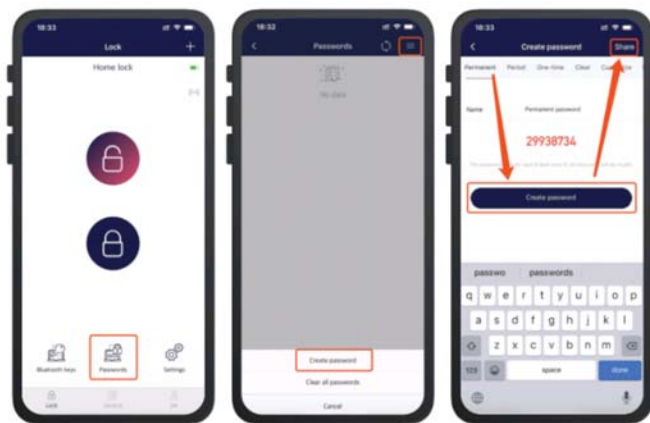

Note: Make sure the receiver's account has already been REGISTERED in Populife App.

Features and Settings

1. Default keypad password

In "Factory mode" (Before pairing), the default keypad password is 123456.

You can enter 123456# on lock keypad to unlock.

Note: Once the lock is paired in App, the default password becomes invalid and you can get a new Admin password in "Lock settings" in App. If you delete the lock from App, the password 123456 becomes valid again.

2. Private mode

If you want to stay alone, you can enable the "Private mode" by long-pressing the private button on inside door panel until a beep sound. Others will not be able to get in via App or password.

And if you want to disable the mode, just thumb turn knob to open the lock.

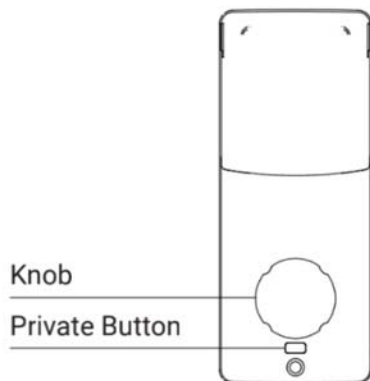

Features and Settings

3. In App "Lock settings" page, you can view and set the configurations of the lock, such as lock battery, admin password, lock time, automatic locking, lock operation records, delete(unpair) lock and so on.

